

CONDOMINIUM FLOOR PLAN  
 NO. 2103  
 RECORDED 9.20.07 3:15 PM



THE UNDERSIGNED, A REGISTERED ARCHITECT HAS VISITED THE SITE KNOWN AS POINT SATELLITE CONDOMINIUM, AND VIEWED THE PROPERTY AND TO THE BEST OF HIS KNOWLEDGE, INFORMATION, AND BELIEF, (a) THE EXTERIOR WALLS AND ROOF OF EACH STRUCTURE ARE IN PLACE AS SHOWN ON THESE PLANS, (b) THE EXTERIOR FINISHES, CEILINGS, TO THE EXTENT SHOWN ON SAID PLANS, AS CONSTITUTE THE HORIZONTAL BOUNDARIES, IF ANY, AND THE VERTICAL BOUNDARIES OF EACH UNIT, INCLUDING CONVERTIBLE SPACE, HAVE BEEN SUFFICIENTLY CONSTRUCTED SO AS TO ESTABLISH THE PHYSICAL BOUNDARIES OF SUCH UNIT.

WILLIAM DONOFRIO  
 REGISTERED ARCHITECT  
 STATE OF GEORGIA  
 NO. 019261

THIS FLOOR PLAN AND THE DIMENSIONS AND SQUARE FOOTAGE CALCULATIONS SHOWN HEREON ARE ONLY APPROXIMATIONS. ANY UNIT OWNER WHO IS CONCERNED ABOUT ANY REPRESENTATIONS REGARDING THIS FLOOR PLAN SHOULD CONSULT AN INVESTIGATOR AS TO THE DIMENSIONS, MEASUREMENTS AND SQUARE FOOTAGES OF THE UNIT.

POINT SATELLITE CONDOMINIUM  
 DULUTH, GA



POINT SATELLITE, LLC  
 09/19/2007

1 BUILDING B- FIRST FLOOR  
 Scale: N.T.S.  
 0 20' 40'

COPYRIGHT © 2007 GSK DESIGN LLC





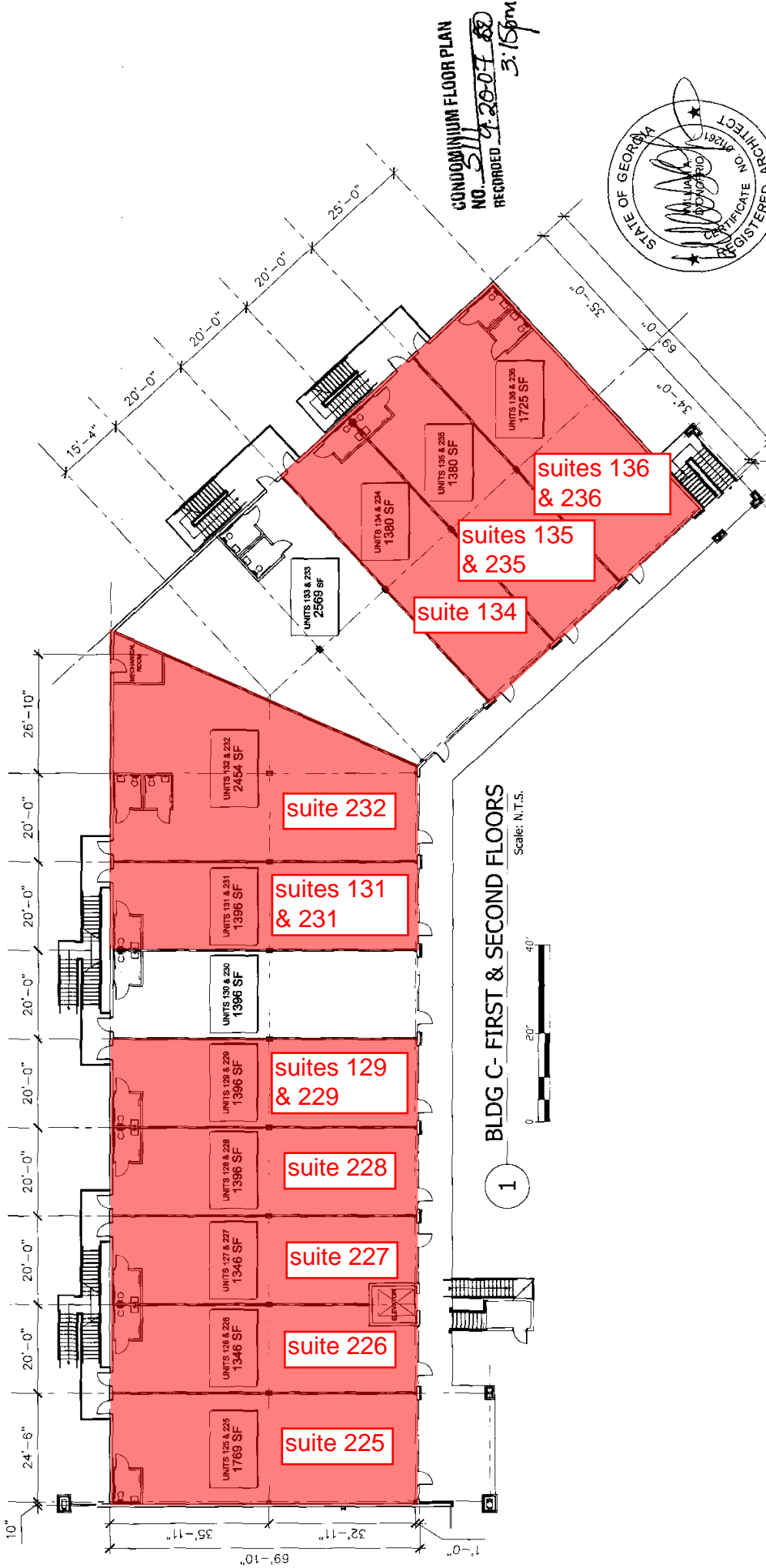

CONDOMINIUM FLOOR PLAN  
 NO. 511 2007 8  
 RECORDED 3:15pm

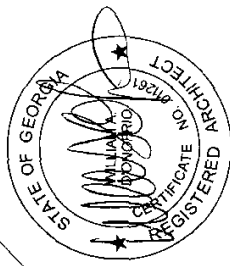

THE UNDERSIGNED, A REGISTERED ARCHITECT, HAS VISITED THE SITE KNOWN AS POINT SATELLITE CONDOMINIUM AND VIEWED THE PROPERTY AND TO THE BEST OF HIS KNOWLEDGE, INFORMATION, AND BELIEF, (a) THE EXTERIOR WALLS AND ROOF OF EACH STRUCTURE ARE IN PLACE AS SHOWN ON SAID PLANS, AND (b) SUCH WALLS, PARTITIONS, FLOORS, AND ROOFS ARE CONSTRUCTED IN ACCORDANCE WITH THE HORIZONTAL BOUNDARIES, IF ANY, AND THE VERTICAL BOUNDARIES OF EACH UNIT, INCLUDING CONVERTIBLE SPACE, HAVE BEEN SUFFICIENTLY CONSTRUCTED SO AS TO ESTABLISH THE PHYSICAL BOUNDARIES OF SUCH UNIT.

WILLIAM D'ONOFRIO  
 COPYRIGHT © 2007 G SIX DESIGN LLC

THE DECLARATION OF CONDOMINIUM FOR POINT SATELLITE CONDOMINIUM IS RECORDED IN DEED BOOK 4821 PAGE 6 OF THE SUPERIOR COURT OF GWINNETT COUNTY, GEORGIA RECORDS.

THIS FLOOR PLAN AND THE DIMENSIONS AND SQUARE FOOTAGE CALCULATIONS SHOWN THEREON ARE APPROXIMATE. ANY UNIT OWNER WHO IS CONCERNED ABOUT ANY REPRESENTATIONS REGARDING THIS FLOOR PLAN SHOULD DO HIS/HER OWN INVESTIGATION AS TO THE DIMENSIONS, MEASUREMENTS AND SQUARE FOOTAGES OF THE UNIT.

BLDG C- FIRST & SECOND FLOORS  
 Scale: N.T.S.

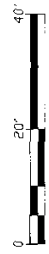

POINT SATELLITE CONDOMINIUM  
 DULUTH, GA



POINT SATELLITE, LLC  
 09/19/2007